



## 5 Webb Lane, Stockport, SK1 4DT

Harratts Property Services is thrilled to present this stunning three-bedroom semi-detached home, ideally located in the highly sought-after area of Stockport.

Upon entering, you are welcomed by a spacious hallway that flows seamlessly into a generously sized lounge, providing the perfect setting to unwind and relax after a long day. From the lounge, you'll find the dining room, which is flooded with natural light through its large window, creating a bright and inviting atmosphere. The kitchen, conveniently located adjacent to the rear reception room, is equipped with a range of eye-level and base units, offering storage and workspace for meal preparation. One of the standout features of this property is the cellar, offering additional storage space to meet all your needs.

Moving upstairs, the first floor boasts three well-proportioned bedrooms. Two spacious double rooms provide ample space for personal furnishings, while the third room is ideal for a single bed or can be utilized as a home office or study. The family bathroom, also on the first floor, is fitted with a bath and overhead shower, wash basin, and WC.

Outside, stepping through the kitchen leads you to the ample rear garden, which features a patio area and a well-maintained lawn, offering a lovely space for outdoor relaxation, dining, or entertaining.

**£250,000**

- Three Bed Semi-Detached Property
- Total Area Of 89 square meters, Including The Additional Cellar Space
- Immaculate Throughout
- Two Double Bedrooms
- Two Reception Rooms
- Rear Garden
- Close To Local Schools And Major Transport Links
- VIEWINGS FRIDAY 25TH APRIL

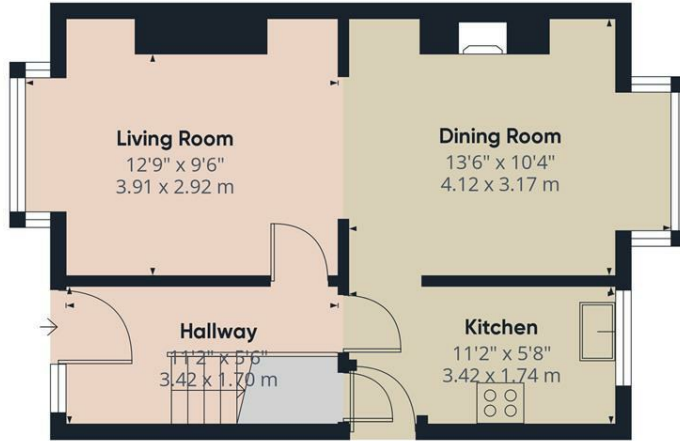

Floor 0

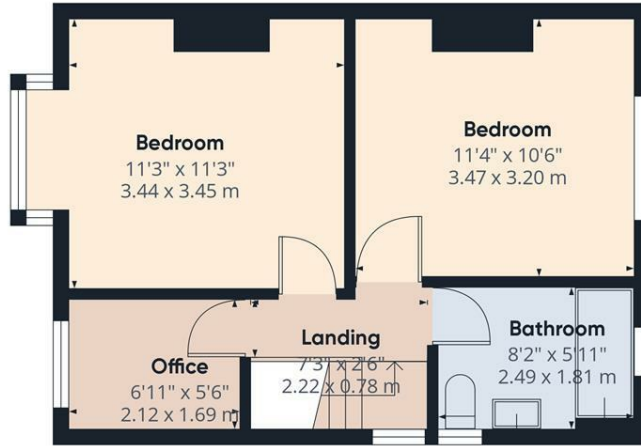

Floor 1

Approximate total area<sup>1)</sup>  
743.79 ft<sup>2</sup>  
69.1 m<sup>2</sup>

(1) Excluding balconies and terraces

While every attempt has been made to ensure accuracy, all measurements are approximate, not to scale. This floor plan is for illustrative purposes only.

Calculations are based on RICS IPMS 3C standard.

GIRAFFE360

