



14 Hawes Close, Stockport, SK2 6DZ

This well-presented three-bedroom mid-terrace home, located on Hawes Close, Heaviley, offers spacious and versatile accommodation, ideal for families or first-time buyers.

Upon entering the property, you are welcomed by an entrance porch leading into a central hallway. To the front of the home is a bright and generously sized lounge, providing a comfortable living space. To the rear, the property boasts an extended open-plan kitchen/diner, creating a fantastic area for both everyday living and entertaining. The kitchen is fitted with a range of eye- and base-level units, offering ample storage and generous worktop space, along with room for utilities. The dining area features double doors that open out onto the patio garden, allowing for plenty of natural light and seamless indoor-outdoor living.

Upstairs, the property comprises two well-proportioned double bedrooms and a third single bedroom, which could also be used as a home office, nursery, or dressing room. The family bathroom is fitted with a bath with shower over, wash basin, and WC.

Externally, the property benefits from a welcoming front garden, while the rear features a private patio garden—perfect for outdoor dining and entertaining. Additionally, there is a garage located close to the property, providing

- Three Bedroom Mid-Terrace Property
- Extended Open Plan Kitchen/Diner
- Two Double Bedrooms
- Patio Garden To Rear
- Garage For Extra Storage
- Close To Local Schools, Amenities & Excellent Transport Links

£260,000

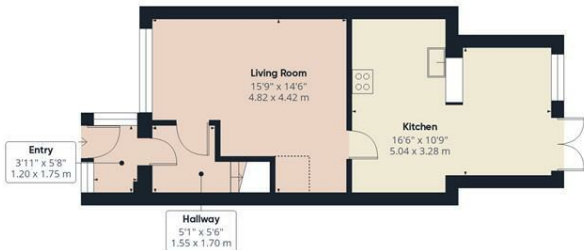

Floor 0 Building 1

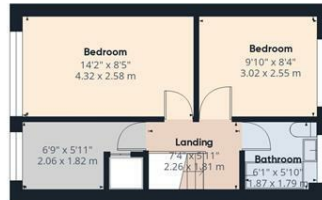

Floor 1 Building 1



Floor 0 Building 2

Approximate total area¹⁾
928 ft²
86.1 m²

Reduced headroom
7 ft²
0.7 m²

(1) Excluding balconies and terraces.

Reduced headroom
----- Below 5 ft/1.5 m

Calculations reference the RICS IPMS 3C standard. Measurements are approximate and not to scale. This floor plan is intended for illustration only.

GIRAFFE360

