



## 7 Hinton Mews Turncroft Lane, Stockport, SK1 4AX

Tucked away on the ever-popular Hinton Mews, off Turncroft Lane in Stockport, this well-presented two-bedroom end-terrace property offers a fantastic opportunity for first-time buyers, downsizers, or investors alike.

Upon entering the home, you are welcomed into a bright and inviting lounge, a comfortable open space perfect for relaxing or entertaining. This flows seamlessly into the kitchen/diner, which is fitted with a range of eye and base level units, providing ample worktop space and room for appliances. The dining area enjoys pleasant views over the rear garden, creating an ideal setting for everyday living.

To the first floor, the property offers two well-proportioned bedrooms, including a generous double bedroom complete with built-in storage, alongside a good-sized single bedroom. A modern family bathroom completes the accommodation, featuring a bath with shower over, wash basin, and low-level WC.

Externally, the property benefits from two off-road parking spaces to the front. To the rear, there is a low-maintenance garden, ideal for outdoor enjoyment, along with a versatile outhouse that can be used for storage, a home office, or hobby space.

- Two Bedroom End-Terrace Property
- Ready To Move Into
- Off Road Parking For Two Vehicles
- Garden To Rear
- Multiuse Out House In Garden
- Popular Location

**£220,000**



Floor 0 Building 1

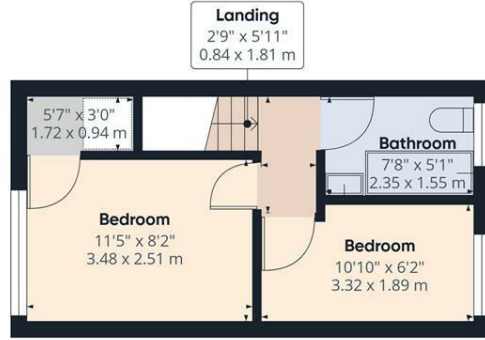

Floor 1 Building 1



Floor 0 Building 2

**Approximate total area<sup>(1)</sup>**  
654 ft<sup>2</sup>  
60.7 m<sup>2</sup>

**Reduced headroom**  
8 ft<sup>2</sup>  
0.7 m<sup>2</sup>

(1) Excluding balconies and terraces

Reduced headroom  
----- Below 5 ft/1.5 m

Calculations reference the RICS IPMS 3C standard. Measurements are approximate and not to scale. This floor plan is intended for illustration only.

GIRAFFE360

